

LEGEND

- 1 EXISTING RESTROOM TO BE DEMOLISHED
- 2 EXISTING GARAGE TO BE DEMOLISHED
- 3 EXISTING WORKSHOP TO BE DEMOLISHED
- 4 EXISTING FLEETWARE BUILDING TO BE DEMOLISHED
- 5 EXISTING TWO STOREY OFFICES TO REMAIN
- 6 EXISTING PLANTROOM, CLEANERS STORES AND TOILETS TO REMAIN

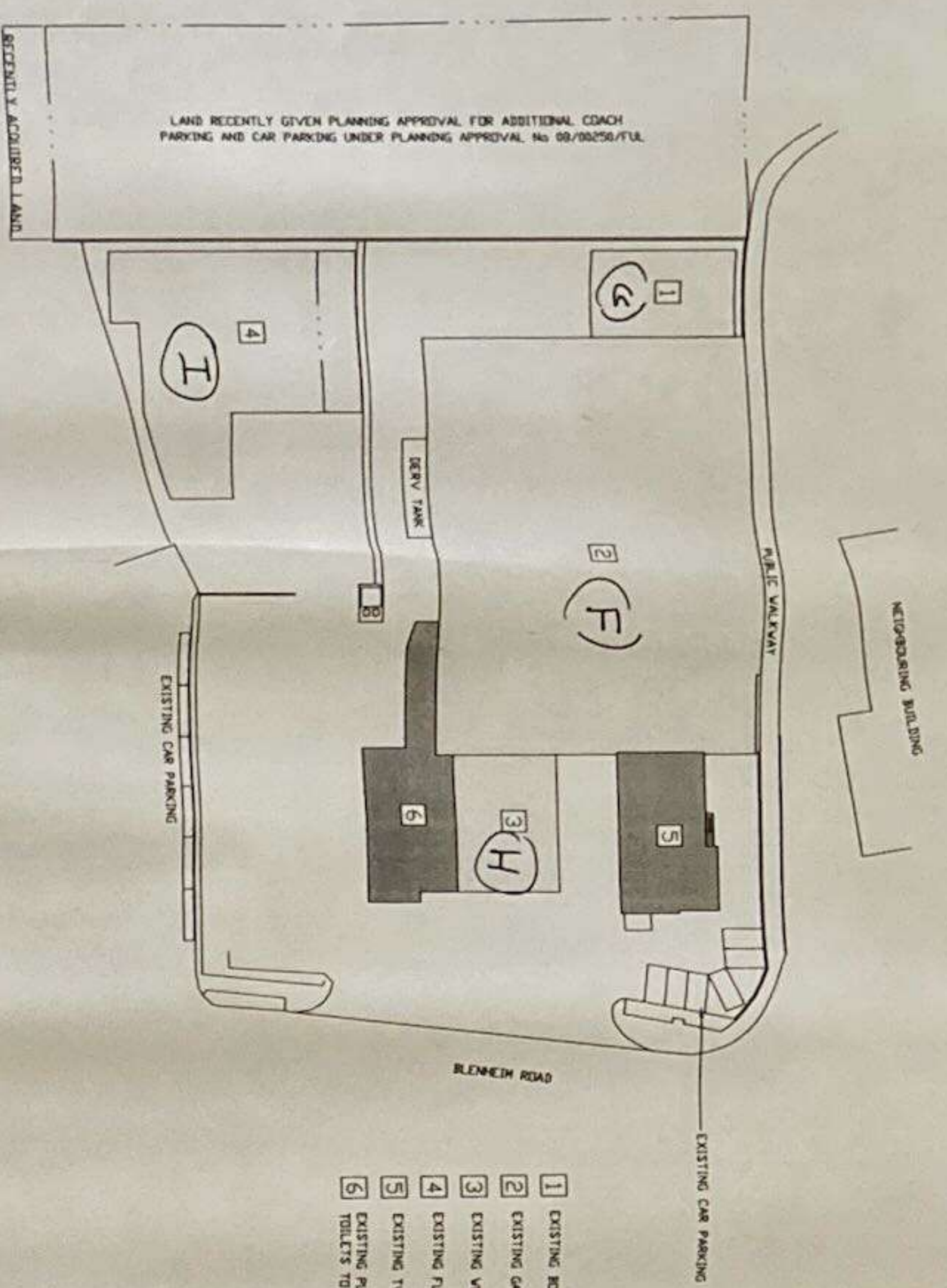

EXISTING SITE LAYOUT PLAN SCALE - 1:500

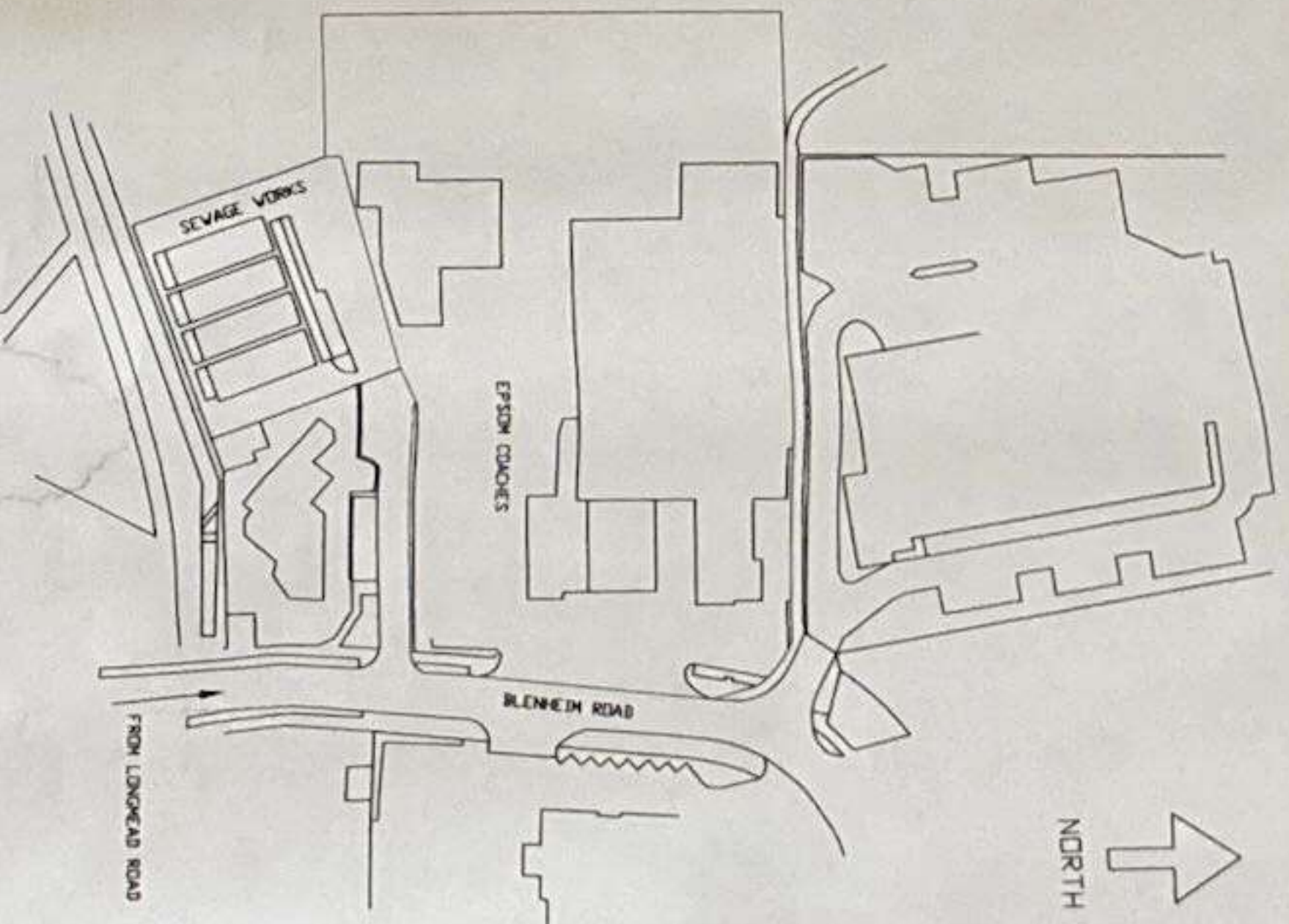

SITE LOCATION PLAN SCALE - 1:1000

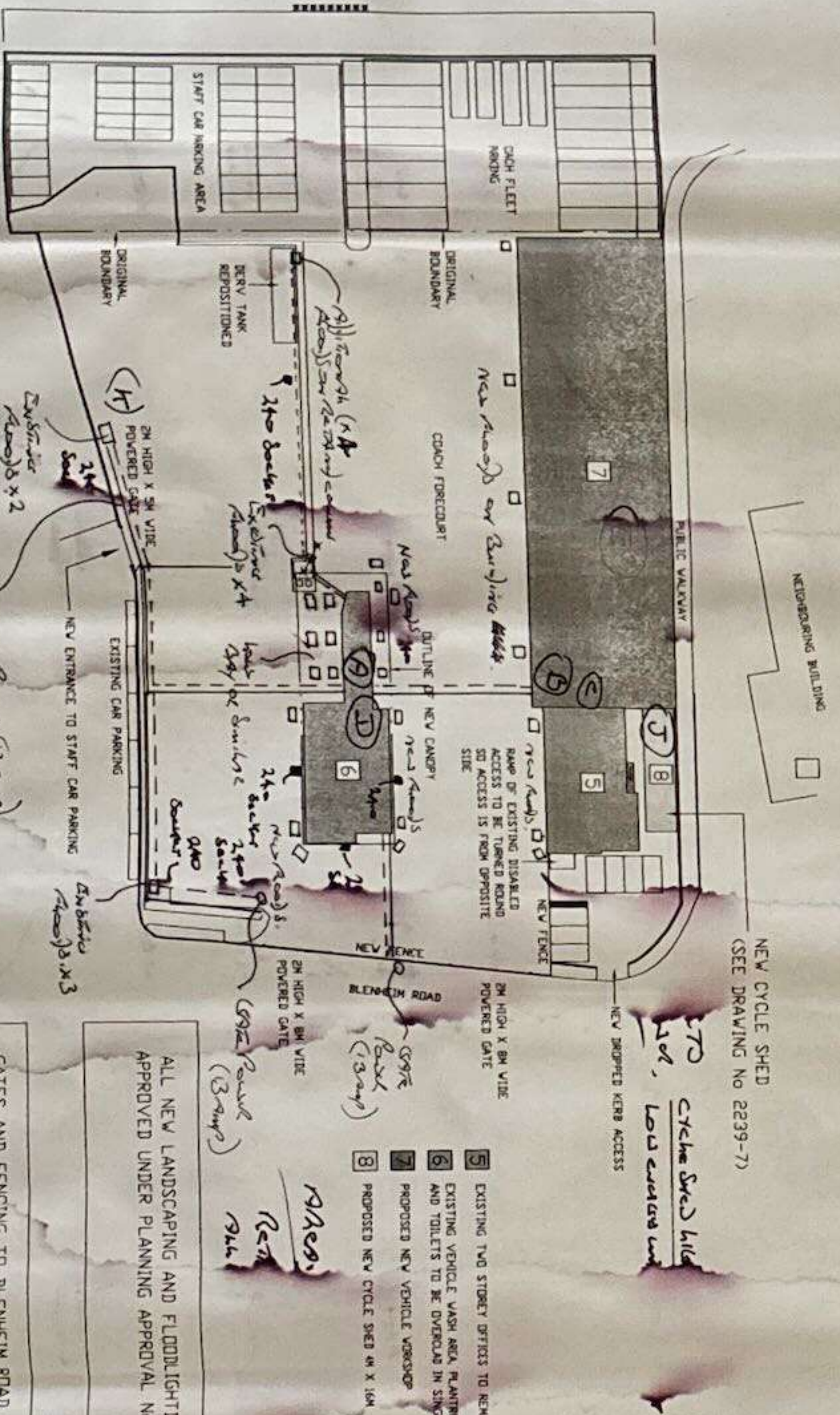

PROPOSED SITE LAYOUT PLAN SCALE - 1:500

GATES AND FENCING TO BLENNHEIM ROAD TO BE 2M HIGH IN BLACK STEEL RAILLING. ALL OTHER BOUNDARIES TO HAVE 3M HIGH GALVANISED MESH AS EXISTING EXCEPT THE BOUNDARY OF THE NEW CAR/COACH PARKING AREAS WHICH WILL HAVE 4M HIGH GALVANISED MESH FENCING

ALL NEW LANDSCAPING AND FLOODLIGHTING TO BE AS APPROVED UNDER PLANNING APPROVAL NO 08/00250/FUL

- 5 EXISTING TWO STOREY OFFICES TO REMAIN
- 6 EXISTING VEHICLE WASH AREA, PLANTROOM, CLEANERS STORES AND TOILETS TO BE OVERCAH IN SINGLE SKIN CLADDING
- 7 PROPOSED NEW VEHICLE WORKSHOP
- 8 PROPOSED NEW CYCLE SHED 4M X 16M

SITE LAYOUT PLANS

**SPRUCE LIMITED**  
 COMMERCIAL, REPAIRS/MAINTENANCE & FINISHING SPECIALISTS  
 SPRUCE LIMITED  
 15-17, POUND LANE,  
 EPSOM, SURREY,  
 KT19 8HT, ENGLAND  
 PHONE: +44 (0)1875 74854  
 FAX: +44 (0)1875 74874  
 E-MAIL: info@spruce.co.uk  
 WEB: www.spruce.co.uk

CLIENT  
**Epsom Coaches**  
 Site Address  
 Blenheim Road  
 Epsom,  
 Surrey, KT19 9AF

PLANNING APPROVAL  
 DRAWING NUMBER | DRAWING DESCRIPTION  
 5491-5A | Site Layout Plans  
 SCALE  
 Various | Existing and Proposed plans  
 DATE | BY | PROJECT MANAGER  
 15.6.09 | PMC | S Pavey

NO	DATE	REVISION DETAILS	BY
R			
Q			
P			
O			
N			
M			
L			
K			
J			
I			
H			
G			
F			
E			
D			
C			
B			
A			

NEW COACH FLEET PARKING AND STAFF CAR PARKING AREAS ALREADY APPROVED BY THE LOCAL AUTHORITY TOGETHER WITH NEW LANDSCAPING SCHEME UNDER PLANNING APPROVAL NO 08/00250/FUL